

Montageanleitung CUBE-LUX STANDARD

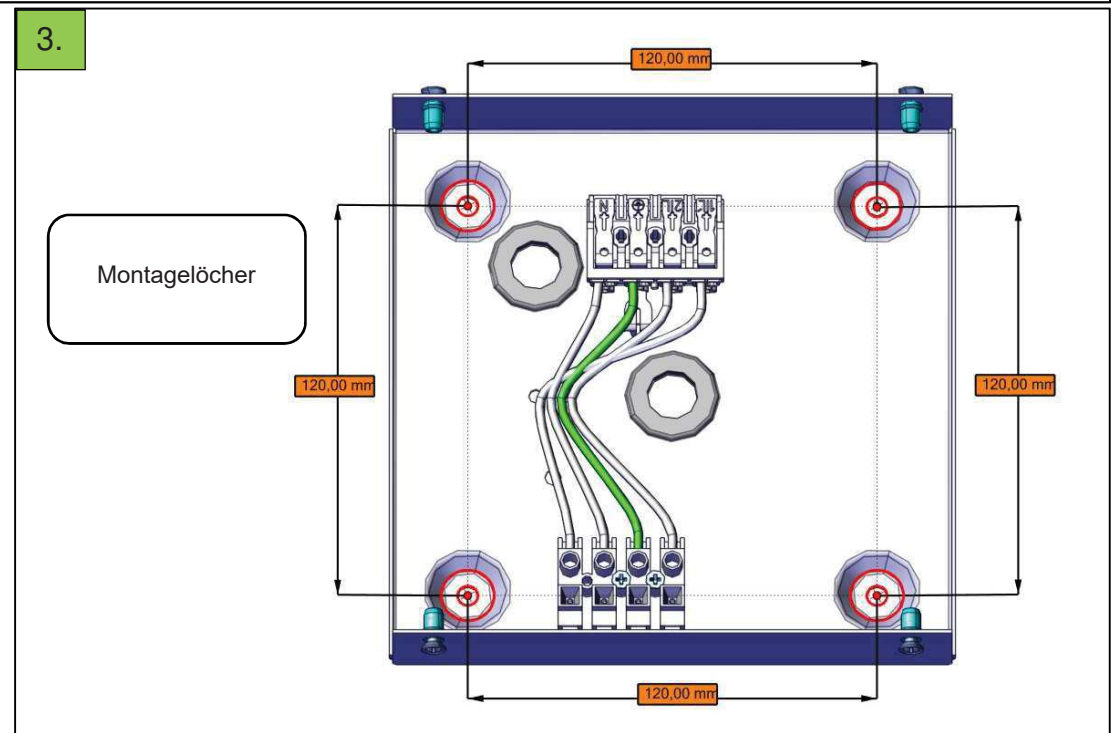
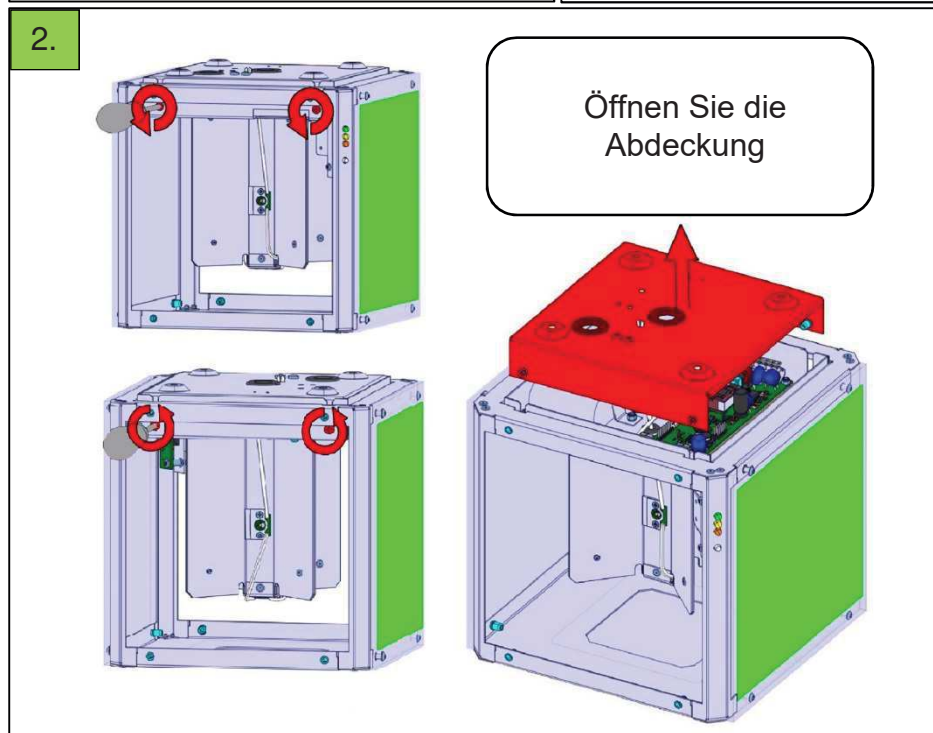
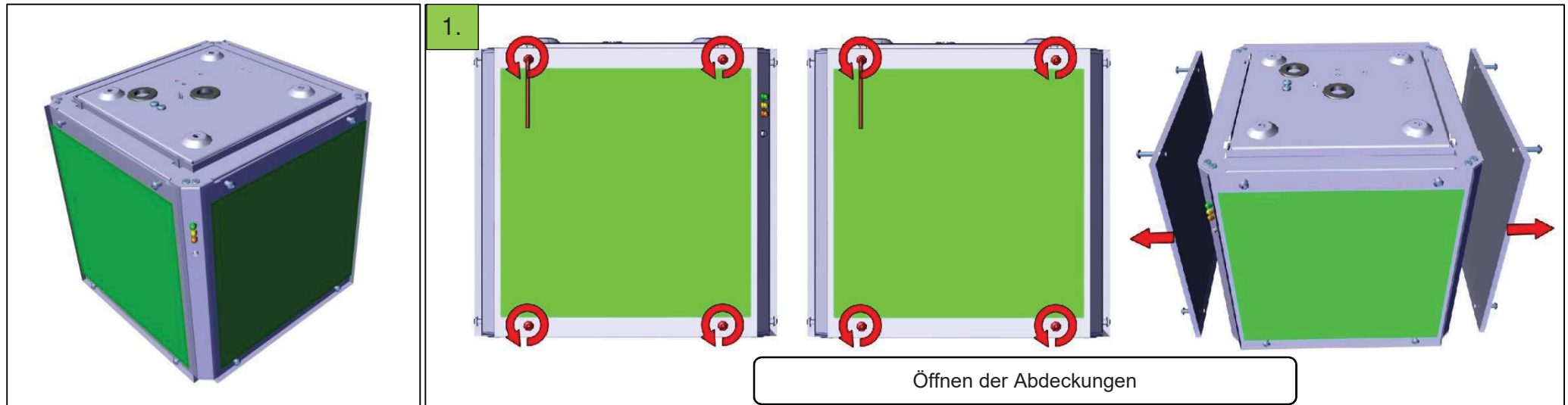

Montageanleitung

CUBE-LUX STANDARD

4.

Anschluss der Netzleitung gemäß Schema

Schema 1:

- Bereitschaftsschaltung

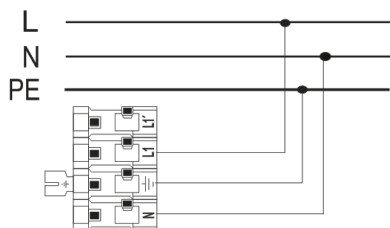

Schema 2:

- Dauerschaltung mit externem Schalter

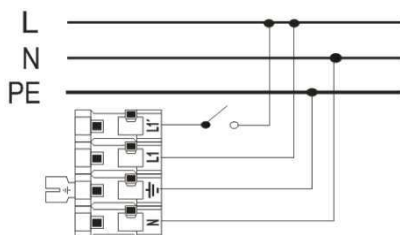

Schema 3:

- Dauerschaltung

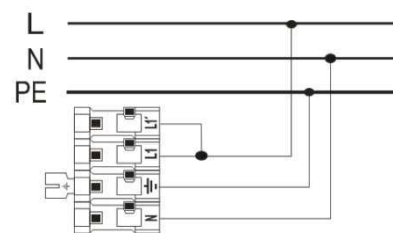

5.

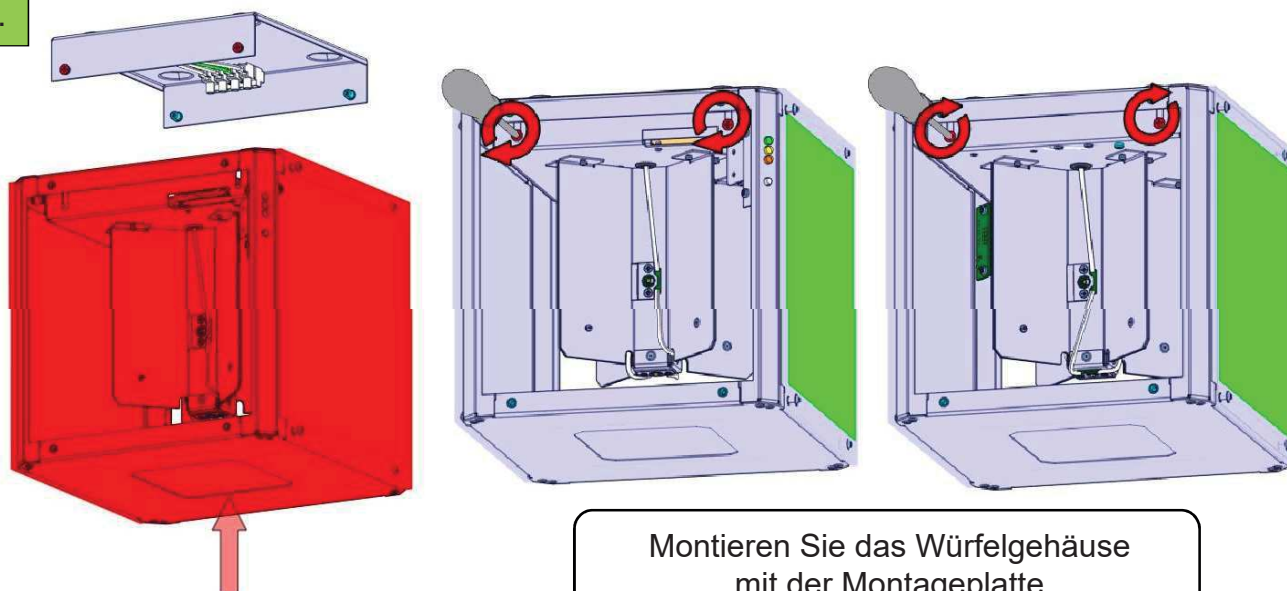

Montieren Sie das Würfelgehäuse mit der Montageplatte

6.

Montieren Sie die Abdeckungen

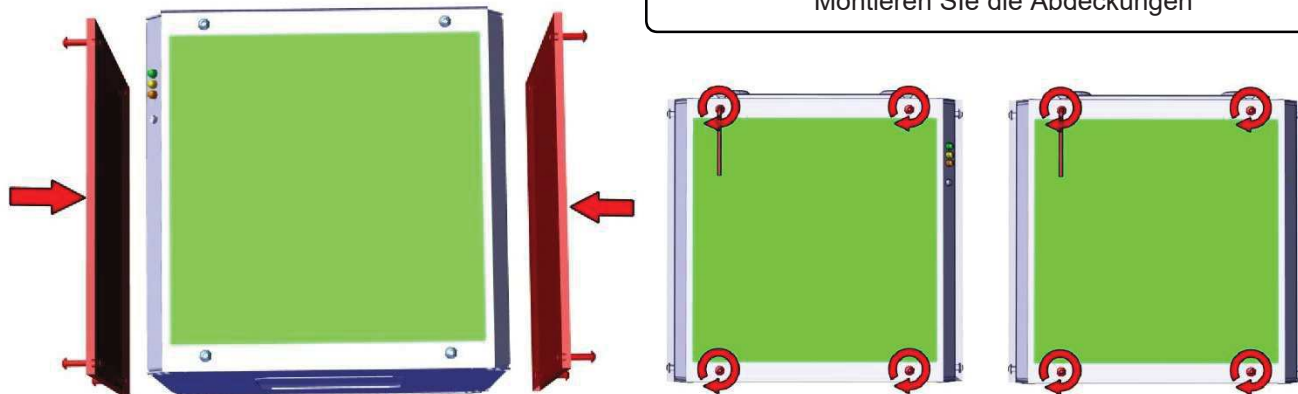

Montageanleitung

CUBE-LUX STANDARD

Austausch des Akkus

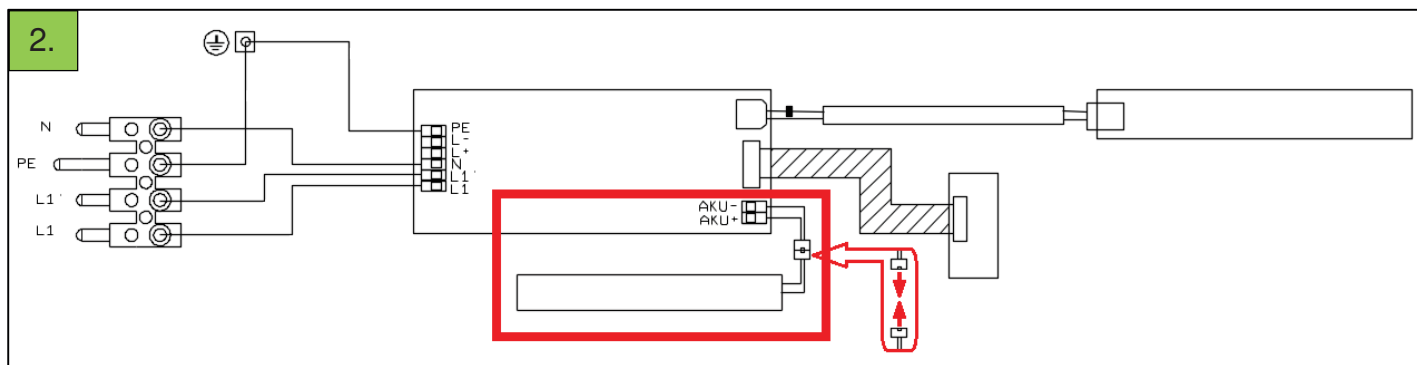
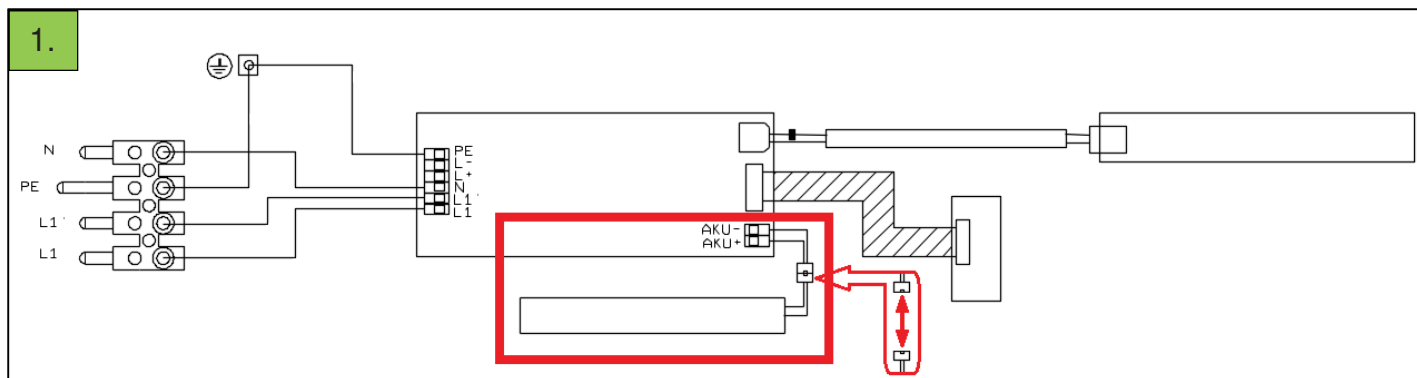

A symbol on the product or its packaging indicate that this product should not go into household waste. It must be taken to the collection point of an electric and electronic equipment recycling facility. By making sure this product is disposed of properly, you will help prevent the negative effects on the environment and human health that would otherwise result from inappropriate disposal of this product.